

PART MUST INSERT FULLY TO SURFACE A IN RECOMMENDED GRID

.021 SQ.(9)
[.53]

.100 MIN.
[2.54]

.500 MAX.
[12.70]

.550 MAX.
[13.97]

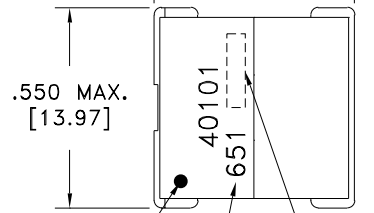
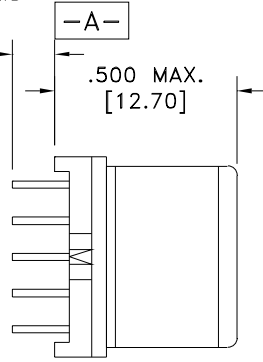
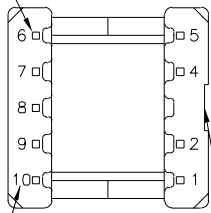

6B
6C

DOT LOCATES TERM. #1

EIA CODE

LOT CODE & DATE CODE

NOTCH LOCATES TERM. 1-5 SIDE

TERM. NO.'s FOR REF. ONLY

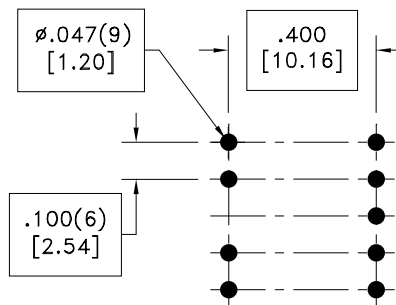
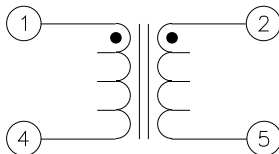

RECOMMENDED P.C. PATTERN, COMPONENT SIDE

6C

ELECTRICAL SPECIFICATIONS @ 25°C unless otherwise noted:

- 6C D.C. RESISTANCE (@20°C): 1-4, 1.50 ohms ±10%.
2-5, 1.50 ohms ±10%.
- DIELECTRIC RATING: 850VDC for 1 second between 1-2.
- 6C INDUCTANCE: 3mH ±10%, 10kHz, 1.0VAC, 0/160mADC, 1-4, Ls.
3mH ±10%, 10kHz, 1.0VAC, 0/160mADC, 2-5, Ls.
- D.C. CURRENT: 80mADC max., 1-5(tie 2+4).
- URNS RATIO: (1-4):(2-5) = 1:1, ±1%.
- 6C INTERWINDING CAPACITANCE: 900pF max., 10kHz, 1.0VAC, 1-2, Cs.
- 6C RESONANT FREQUENCY: 220kHz min., (660kHz typ.), 1-4 & 2-5.

DETAILS SUBJECT TO CHANGE

Midcom, Inc. Watertown, SD USA Toll Free: 800-643-2661 Fax: 605-886-4486	Unless otherwise specified: Tolerances: Fractions: ±1/64 Angles: ±1° Decimals: ±.005(.127mm)		
	DRAWING TITLE <h2 style="text-align: center;">INDUCTOR</h2>	DRAWING NO. <h2 style="text-align: center;">40101</h2>	REV. 6C
This drawing is dual dimensioned. Dimensions in brackets are in millimeters.	REVISIONS: SEE SHEET 1	SCALE ---	SHEET 2 OF 5

DWG.# 40101