

SOLDER SUFFIX	CUSTOMER TERMINAL	RoHS	LEAD(Pb)-FREE
LF1	Sn96%, Ag4%	Yes	Yes

TERM. NO.'s FOR REF. ONLY

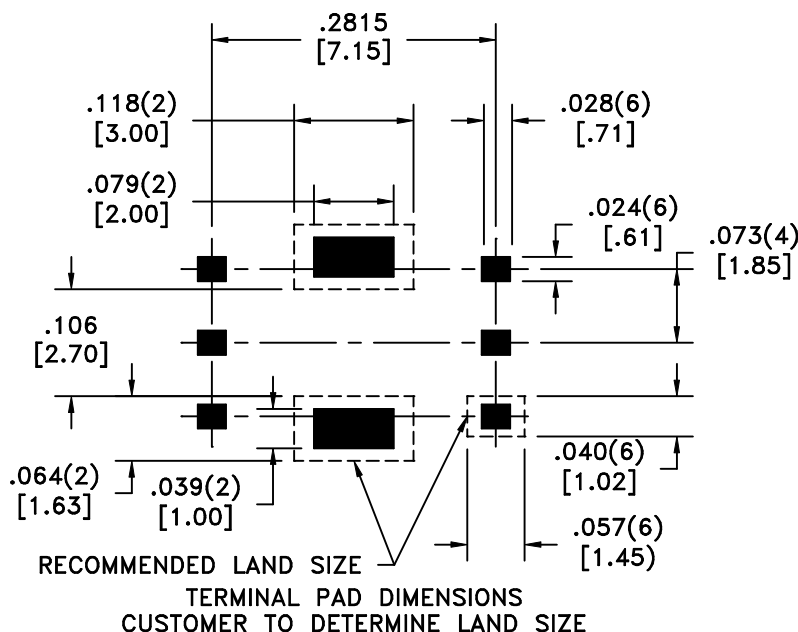
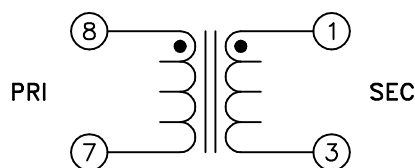
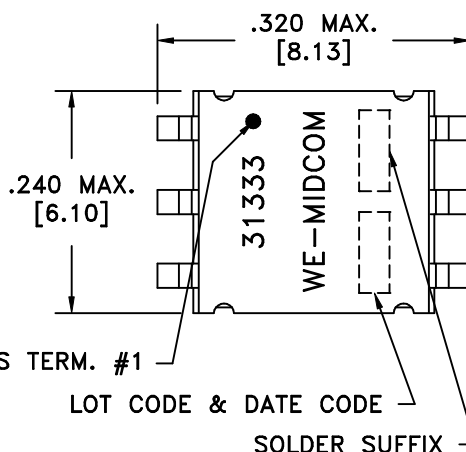
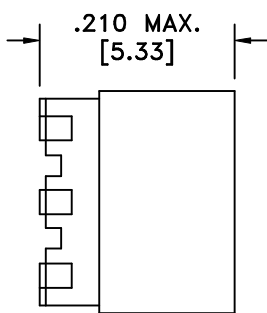
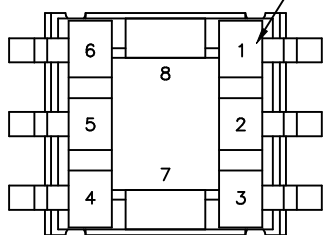

ELECTRICAL SPECIFICATIONS @ 25°C unless otherwise noted:

- D.C. RESISTANCE (@20°C): 1-3, 7.00 ohms max.
- DIELECTRIC RATING: 500VAC, 1 minute tested by applying 625VAC for 1 second between 8-1.
- INDUCTANCE: 2.0mH min., 100kHz, 100mVAC, 1-3, Ls.
- TURNS RATIO: (1-3):(8-7) = 100:1, ±1%.
- PRIMARY RATING: 6.0Arms max.
- OPERATING TEMPERATURE RANGE: -40°C to +85°C.

DETAILS SUBJECT TO CHANGE

Unless otherwise specified:
Tolerances:
Angles: ±1°
Fractions: ±1/64
Decimals: ±.005[.13]

This drawing is dual dimensioned.
Dimensions in brackets are in millimeters.

DRAWING TITLE
TRANSFORMER

eiSos p/n:

REVISIONS: SEE SHEET 1

Midcom WE
www.midcom-inc.com

DRAWING NO.
31333R-LF1

REV.
6A
9/06

SCALE --- SHEET 2 OF 5

DWG.# 31333R-LF1