

PART MUST INSERT FULLY TO SURFACE A IN RECOMMENDED GRID

* DIMENSION MAY BE EXCEEDED WITH SOLDER ONLY

.021 SQ.(10)
[.53]

.100/.130 *
[2.54/3.30]

.500 MAX.
[12.70]

.550 MAX.
[13.97]

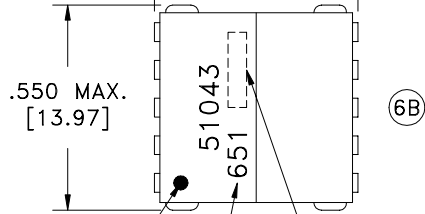
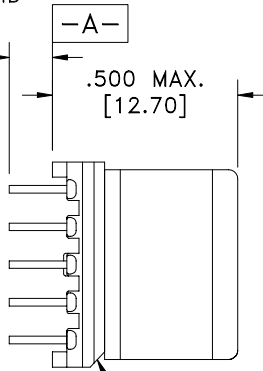
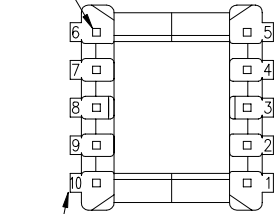

CHAMFERS LOCATE TERM.'s #1 & 10
TERM. NO.'s FOR REF. ONLY

DOT LOCATES TERM. #1

EIA CODE

LOT CODE & DATE CODE

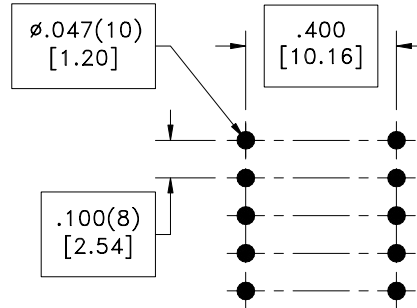
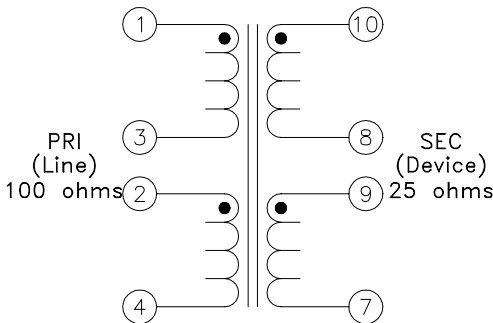

RECOMMENDED
P.C. PATTERN, COMPONENT SIDE

ELECTRICAL SPECIFICATIONS @ 25°C unless otherwise noted:

- LONGITUDINAL BALANCE: 45dB min., 23k - 1.2MHz, per ITU Method (L->M).
- D.C. RESISTANCE (@20°C):
 - 1-3, 0.46 ohms ±10%.
 - 2-4, 0.46 ohms ±10%.
 - 10-8, 0.19 ohms ±10%.
 - 9-7, 0.27 ohms ±10%.
- INSERTION LOSS: 0.5dB max., at 100kHz, 25 ohm load.
- DIELECTRIC RATING: 1500VAC, 1 minute tested by applying 1875VAC for 1 second between 1-10; 2-10; 1-9; 2-9.
- INDUCTANCE: 518uH ±5%, 25kHz, 100mVAC, 1-4(tie 2+3), Ls.
- LEAKAGE INDUCTANCE:
 - 8.5uH max., 100kHz, 100mVAC, 1-4(tie 2+3, 8+9, 7+10), Ls.
 - 2.5uH max., 100kHz, 100mVAC, 10-7(tie 2+3, 8+9, 1+4), Ls.
- TURNS RATIO: (1-4):(10-7) = 2:1, tie(2+3, 8+9), ±1%.
- TOTAL HARMONIC DISTORTION: -70dB typ., 100kHz, 20Vp-p, 100 ohm load, 25 ohm input, tie(2+3, 8+9).

DETAILS SUBJECT TO CHANGE

Midcom, Inc.
Watertown, SD USA
Toll Free: 800-643-2661
Fax: 605-886-4486

Unless otherwise specified:
Tolerances: Fractions: ±1/64
Angles: ±1° Decimals: ±.005[.13]

DRAWING TITLE
TRANSFORMER

Midcom

DRAWING NO.

51043

REV.

6B
1/04

REVISIONS: SEE SHEET 1

SCALE ---

SHEET 2 OF 6

This drawing is dual dimensioned.
Dimensions in brackets are in millimeters.

DWG.# 51043