

SOLDER SUFFIX	CUSTOMER TERMINAL	RoHS	LEAD(Pb)-FREE
	Sn63%, Pb37%	No	No
LF1	Sn96%, Ag4%	Yes	Yes

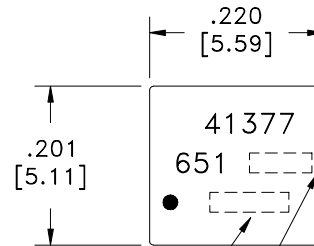

SOLDER SUFFIX
 LOT CODE & DATE CODE

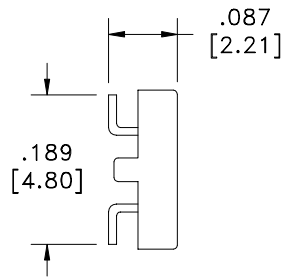
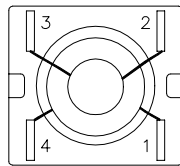
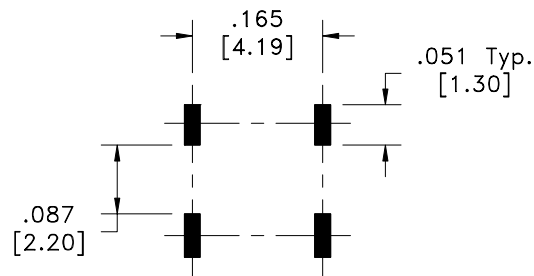
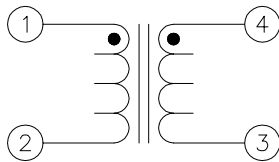

CUSTOMER TO DETERMINE LAND LAYOUT

ELECTRICAL SPECIFICATIONS @ 25°C unless otherwise noted:

D.C. RESISTANCE (@20°C): 1-2, TBD ohms max.
 4-3, TBD ohms max.

DIELECTRIC RATING: 1500VAC, 1 minute tested by applying 1875VAC for 1 second between 1-4.

INDUCTANCE: 2.2uH±30%, 100kHz, 10mVAC, 1-2, Ls.

TURNS RATIO: (1-2):(4-3) = 1:1, ±1%.

COMMON MODE ATTENUATION: -?dB typ., 1MHz.
 -?dB typ., 30MHz.
 -?dB typ., 100MHz.

Preliminary!

DETAILS SUBJECT TO CHANGE

Midcom, Inc.
 Watertown, SD USA
 Toll Free: 800-643-2661
 Fax: 605-886-4486
 This drawing is dual dimensioned.
 Dimensions in brackets are in millimeters.

Unless otherwise specified:
 Tolerances: Fractions: ±1/64
 Angles: ±1° Decimals: ±.005 [.13]
 DRAWING TITLE
 INDUCTOR
 REVISIONS: SEE SHEET 1

Midcom
 DRAWING NO.
 41377R/-LF1
 SCALE --- SHEET 2 OF 5
 REV.
 00
 6/06

DWG # 41377R/-LF1