

SOLDER SUFFIX	CUSTOMER TERMINAL	RoHS	LEAD(Pb)-FREE
	Sn63%, Pb37%	No	No
LF1	Sn96%, Ag4%	Yes	Yes

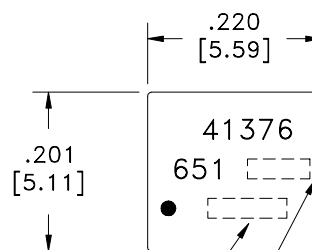

SOLDER SUFFIX
 LOT CODE & DATE CODE

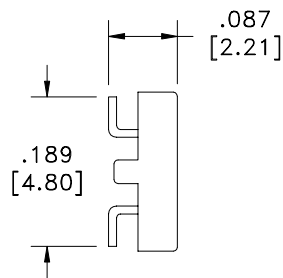
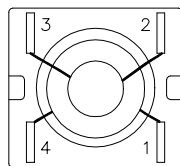
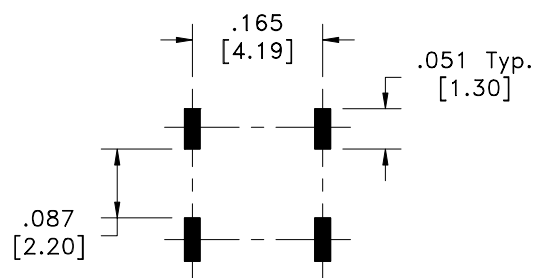
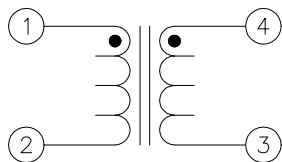

CUSTOMER TO DETERMINE LAND LAYOUT

ELECTRICAL SPECIFICATIONS @ 25°C unless otherwise noted:

D.C. RESISTANCE (@20°C): 1-2, TBD ohms max.
 4-3, TBD ohms max.

DIELECTRIC RATING: 1500VAC, 1 minute tested by applying 1875VAC for 1 second between 1-4.

INDUCTANCE: 42uH±30%, 100kHz, 10mVAC, 1-2, Ls.

TURNS RATIO: (1-2):(4-3) = 1:1, ±1%.

COMMON MODE ATTENUATION: -?dB typ., 100kHz.
 -?dB typ., 10MHz.
 -?dB typ., 50MHz.

Preliminary!

DETAILS SUBJECT TO CHANGE

Midcom, Inc. Watertown, SD USA Toll Free: 800-643-2661 Fax: 605-886-4486	Unless otherwise specified: Tolerances: Fractions: ±1/64 Angles: ±1° Decimals: ±.005[.13]			DWG # 41376R/-LF1
	DRAWING TITLE <h1 style="text-align: center;">INDUCTOR</h1>	DRAWING NO. <h1 style="text-align: center;">41376R/-LF1</h1>	REV. 00 6/06	
This drawing is dual dimensioned. Dimensions in brackets are in millimeters.	REVISIONS: SEE SHEET 1	SCALE ---	SHEET 2 OF 5	