

TERM. NO.'s FOR REF. ONLY

.480 REF.  
[12.19]

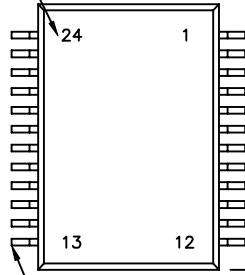

.018 X .010(24)  
[.46 X .25]

.073 REF.  
[1.85]

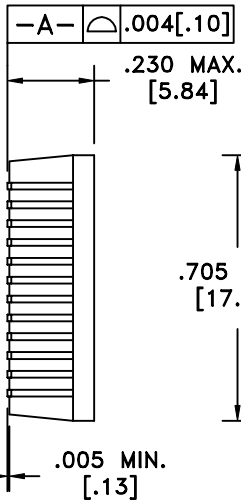

DOT LOCATES TERM. #1

.620 ±.010  
[15.75 ±.25]

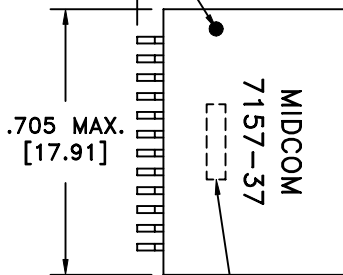

LOT CODE & DATE CODE

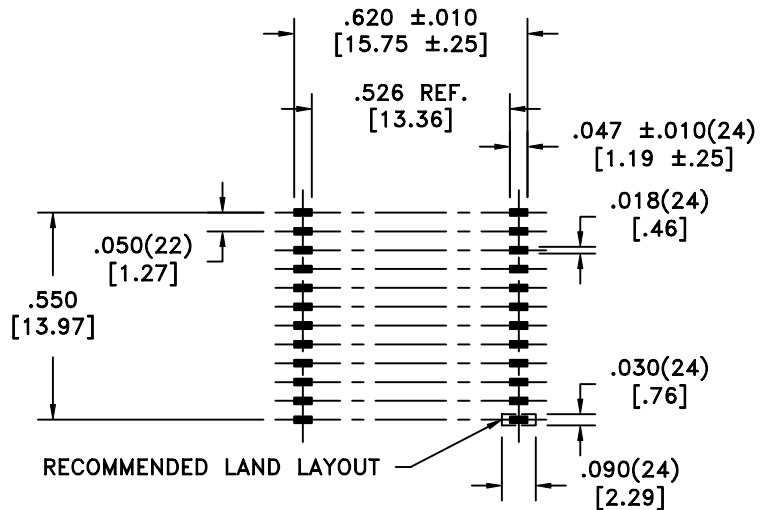
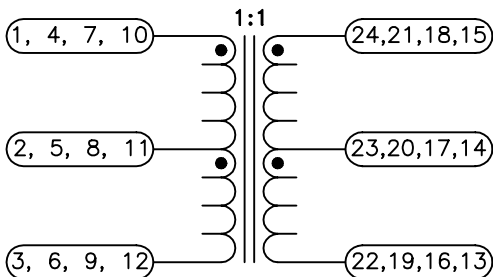

RECOMMENDED LAND LAYOUT

TERMINAL PAD DIMENSIONS  
CUSTOMER TO DETERMINE LAND SIZE

**ELECTRICAL SPECIFICATIONS @ 25°C unless otherwise noted:**

- D.C. RESISTANCE: 1-3; 4-6; 7-9; 10-12; 24-22; 21-19; 18-16; 15-13, 0.2 ohms max.
- DIELECTRIC RATING: 1500Vrms, 1 minute tested by applying 1800Vrms for 1 second between Input-Output.
- INDUCTANCE: 30uH min., 100kHz, 100mVAC, 1-3; 4-6; 7-9; 10-12, Lp.
- LEAKAGE INDUCTANCE: 100nH max., 1MHz, 100mVAC, 1-3(tie 24+22); 4-6(tie 21+19); 7-9(tie 18+16); 10-12(tie 15+13), Ls.
- URNS RATIO & POLARITY: (1-3):(24-22) = 1:1, ±2%. (7-9):(18-16) = 1:1, ±2%.  
(4-6):(21-19) = 1:1, ±2%. (10-12):(15-13) = 1:1, ±2%.
- INTERWINDING CAPACITANCE: 6pF max., 100kHz, 100mVAC, 1-24(tie 1+3, 24+22); 4-21(tie 4+6, 21+19); 7-18(tie 7+9, 18+16); 10-15(tie 10+12, 15+13), Cs.
- CROSSTALK: -40dB min., 1M - 100MHz.
- OPERATING TEMPERATURE RANGE: 0°C to +70°C.
- COPLANARITY: All 24 terminals must lie on a plane within .004 [.10] of Surface A after lead tinning.

**Midcom, Inc.**  
Watertown, SD USA  
Toll Free: 800-643-2661  
Fax: 605-886-4486

This drawing is dual dimensioned.  
Dimensions in brackets are in millimeters.

Unless otherwise specified:  
Tolerances: Fractions: ±1/64  
Angles: ±1° Decimals: ±.005 [.13]

DRAWING TITLE  
**TRANSFORMER**  
PDFP-G24

REVISIONS: SEE SHEET 1

**Midcom**

DRAWING NO.  
**000-7157-37R**

REV.  
6A  
10/01

SCALE --- SHEET 2 OF 8

DWG.# 000-7157-37R